

# SOLDER TERMINALS - MOULDED DAP, SLOTTED

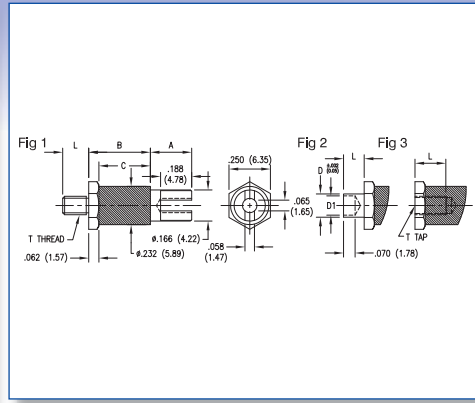
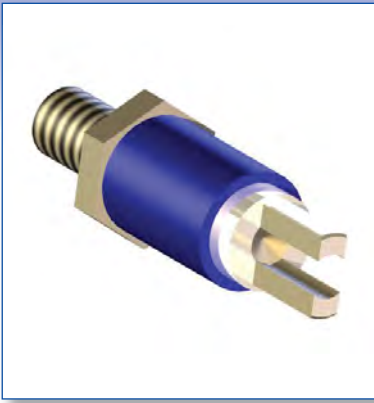

Dimensions in inches (mm)  
See page 94 for recommended Anvil and Punch

**How to order code**

**572 - 48XX - XX - XX - 16**

Basic Part No. | Insulator Colour | Terminal Finish

Material Code Table		
Component	Material	RoHS
Insulator	Diallyl	✓
Mounting Stud	Brass	✓
Terminal	Brass	✓

Finish Code Table			
Dash No.	Terminal Finish	Mtg. Stud Finish	RoHS
-01	Silver	Cadmium	X
-05	Electro-Solder	Cadmium	X
-21	Silver	Nickel	✓

Insulation Colour Code Table	
Dash No.	Colour
-16	Blue

Fig.	Basic Part No.	L	Board Thickness	A	B	C	D	D1	T	IR (RMS)
1	572-4858 -01	.219 (5.56)	-	.250 (6.35)	.375 (9.53)	.312 (7.92)	-	-	4-40	6000
	572-4859 -01	.219 (5.56)	-	.250 (6.35)	.375 (9.53)	.312 (7.92)	-	-	6-32	6000
	-02	.250 (6.35)	-							
	-03	.375 (9.53)	-							
2	572-4864 -01	.219 (5.56)	-	.250 (6.35)	.594 (15.09)	.531 (13.49)	-	-	4-40	6000
	572-4860 -01	.094 (2.39)	.062 (1.57)	.250 (6.35)	.375 (9.53)	.312 (7.92)	.098 (2.49)	.064 (1.63)	-	6000
	-02	.125 (3.18)	.094 (2.39)							
	-03	.156 (3.96)	.125 (3.18)							
	-04	.234 (5.94)	.188 (4.78)							
	572-4861 -01	.094 (2.39)	.062 (1.57)	.250 (6.35)	.375 (9.53)	.312 (7.92)	.141 (3.58)	.116 (2.95)	-	6000
	-02	.125 (3.18)	.094 (2.39)							
	-03	.156 (3.96)	.125 (3.18)							
3	572-4862 -01	.156 (3.96)	-	.250 (6.35)	.375 (9.53)	.312 (7.92)	-	-	4-40	6000
	572-4863 -01	.156 (3.96)	-	.250 (6.35)	.375 (9.53)	.312 (7.92)	-	-	6-32	6000
	572-4868 -01	.219 (5.56)	-	.250 (6.35)	.594 (15.09)	.531 (13.49)	-	-	4-40	6000
	572-4869 -01	.219 (5.56)	-	.250 (6.35)	.594 (15.09)	.531 (13.49)	-	-	6-32	6000